

# SnowGuardWarehouse.com

Snow Guards and Rails for All Types of Roofs

Joseph Jenkins, Inc., 143 Forest Lane, Grove City, PA 16127 USA: Ph: 814-786-9085  
Toll Free: 866-641-7141; Fax: 814-786-8209 Email: mail@josephjenkins.com

## 1.0 PRODUCT NAME

BERGER 640 Snow Guard

## 2.0 MANUFACTURER

Berger Building Products, Inc  
805 Pennsylvania Blvd.  
Feasterville, PA 19053  
info@bergerbuildingproducts.com  
(215) 355-1200  
(800) 523-8852  
(215) 355-7738 (FAX)

## 3.0 DESCRIPTION

**Basic Use:** BERGER 640 Snow Guard is a device designed for the prevention of damage caused by the sliding of snow and ice on metal roof panels.

**Limitations:** The 640 Snow Guard is designed to be adhered to the pan surface of pre-finished metal roofs including batten and lap seam panels and other profiles. When installing a BERGER 640 Snow Guard using only the SB-190\*\* adhesive/sealant, allow 28 consecutive days of at least 50°F or warmer to permit the adhesive/sealant to cure completely. In some extreme cases, temporary measures may need to be employed to hold the snow guard in place until the adhesive begins to cure.

**Finish Styles:** BERGER 640 Snow Guards are manufactured in three finishes; Mill Finish, Primer Finish, and Custom Color Finish. The mill finished style is an unpainted aluminum casting. The primed is E Coated using a Cathodic Electro Deposition process. The CED Epoxy primer has a black color and extended shelf life that can be top coated by contractors with a wet or dry paint system. This primer must be top coated prior to installation. BERGER will also provide the 640 Snow Guard in a custom color finish. Imron®\* polyurethane enamel paint is used for the custom color finish and can be matched to virtually any non-metallic paint finish.

## 4.0 INSTALLATION

### Adhesive Attachment

Before installing, all contact surfaces should be wiped with Isopropyl Alcohol and allowed to dry completely. The adhesive/sealant should be applied in a manner that will completely coat the underside of the device before positioning it on the roof surface. After adhesive/sealant is applied, sufficient compression should be created to squeeze the adhesive/sealant out around the perimeter. Also, a bead of the same material should be applied around the base of the guard to create a waterproof joint that will be free of gaps and air pockets

## Mechanical Attachment

BERGER 640 Snow Guards can be attached using through fasteners and are provided with starter dimple to designate screw position. Stainless steel or corrosion resistant fasteners with neoprene washer should be used.

## Snow Guard Placement

Snow Guard placement will vary from region to region. Roof pitch, as well as lengths of runs and seam spacing influence the layout. Local custom may not be the best guide as to placement. Additional recommendations can be found in SMACNA and other industry standards. BERGER can provide free custom layout design. Ultimately, placement should be determined by a qualified design professional

## 5.0 AVAILABILITY, COST & TECHNICAL SERVICE

BERGER 640 Snow Guards are in stock and ready for immediate shipment from BERGER. Call (800) 523-8852 for cost and additional information or technical assistance.

## 6.0 WARRANTY

Berger Building Products, Inc (BBPI) warrants that the products it manufactures shall be free from material defects. Should any of the products prove defective, the obligation of BBPI under this warranty shall be limited to replacement of the defective product or at our option the cost of the product originally shipped by Berger. This warranty is expressly in lieu of all other warranties expressed or implied including the warranties of merchantability and fitness for a particular purpose. There are no warranties, which extend beyond the description on the face hereof. BBPI in no event, whether claim is based on warranties, contract negligence or otherwise, is liable for incidental or consequential damages. Berger Building Products, Inc (BBPI) will not be responsible for misapplication or modification of product, incorrect material or defects that were obvious at time of installation. Any consequential damage, schedule delays, additional labor, and or equipment rental costs will not be BBPI responsibility. Any BBPI product warranty claim is limited solely to Berger Building Products, Inc

Product Properties	BERGER Real Tool® 640 Snow Guard
Material	ALMAG 35, 535 Alloy ASTMB26 QQ-A-601E 40,000 PSI Ultimate Tensile Strength 20,000 PSI Ultimate Yield Strength
Color / Finish	Mill Finish
	Black Primer
	Custom Color
Weight per piece	.160 lbs.- Aluminum
Pieces per box	50

\*Imron® is a registered trademark of Dupont  
\*\*SB-190 Everseal is a product of Surebond, Inc.

## BERGER 640 Surface Mount Snow Guards

### Installation Instructions

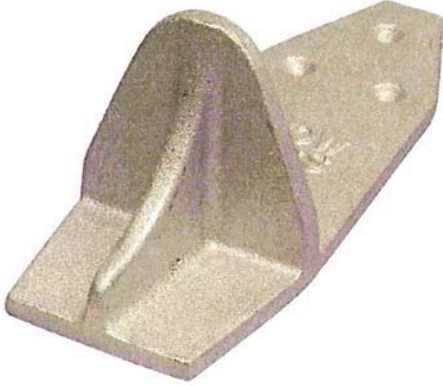

The 640 snow guard can be installed using adhesive sealants, mechanical fasteners or a combination of both. Its primary design is to accommodate flat pans of metal roofs.

**Adhesive Recommendation:** BERGER recommends Surebond Everseal (SB-190)\* when using adhesive to install the 640. This product has been proven in the industry for this particular use. Strict compliance with the manufacturer's recommendations regarding environment conditions and surface preparation will assure optimum performance. SB-190 requires 28 days (672 consecutive hours) of 50 degrees Fahrenheit, or warmer temperatures to fully cure to 2000psi shear tensile strength. Do not use adhesive if rain is forecast within 24 hours.

**Adhesive Attachment:** All surface areas that are to come in contact with sealant are to be wiped with isopropyl alcohol and allowed to dry. Adhesive or sealant should be applied so as to completely cover the underside of the device before it is positioned, and sufficient compression should be created to squeeze adhesive out around its perimeter

and a bead of the same material should be applied around the base to create a waterproof joint free of gaps and air pockets. Each 10.3 oz tube of sealant will adhere approximately 10 to 12 guards. It should be noted that under certain conditions, temporary measures may need to be employed to hold the snow guard in place until initial set of adhesive has taken place.

**Mechanical Attachment.** The 640 is provided with starter pilot dimples for #10 Type A self-tapping fasteners, (flat or oval head) with a neoprene washer for a watertight seal. The Snow Guard needs to be fastened into a structural member, rafter or purlin at least 1.5" through each screw point. Fastener selection should be governed by substrate and anticipated loads; stainless steel or corrosion resistant fasteners should be insisted upon.

**"Screw and Glue" Attachment:** The 640 may also be installed using a combination of fasteners (screw) and adhesive (glue) or a suitable high-quality silicone sealant

**Snow guard Placement** will vary from region to region and will be influenced by roof pitch, as well as the lengths of runs and spacing between seams. Local custom may not be the best guide as to placement, and additional recommendations can be found in SMACNA and other published industry standards. Ultimately, placement should be determined by a qualified design professional.

**Berger does not warrant adhesive failure.** The adhesives are offered for the convenience of the user who assumes full responsibility for its use. These adhesives are used throughout the industry for adhering snow guards with successful results utilizing the directions of the adhesive manufacturer. Recommended for use only when weather conditions permit proper curing per manufacturer's instructions. **Adhesive failure does not constitute Berger products defect and is not the responsibility of Berger.**

Berger Building Products, Inc (BBPI) warrants that the products it manufactures shall be free from material defects. Should any of the products prove defective, the obligation of BBPI under this warranty shall be limited to replacement of the defective product or at our option the cost of the product originally shipped by Berger. This warranty is expressly in lieu of all other warranties expressed or implied including the warranties of merchantability and fitness for a particular purpose. There are no warranties, which extend beyond the description on the face hereof. BBPI in no event, whether claim is based on warranties, contract negligence or otherwise, is liable for incidental or consequential damages. Berger Building Products, Inc (BBPI) will not be responsible for misapplication or modification of product, incorrect material or defects that were obvious at time of installation. Any consequential damage, schedule delays, additional labor, and or equipment rental costs will not be BBPI responsibility. Any BBPI product warranty claim is limited solely to Berger Building Products, Inc

\*Surebond Everseal is a product of Surebond, Inc.

BERGER BUILDING PRODUCTS, INC.  
805 Pennsylvania Boulevard ● Feasterville, PA 19053  
215-355-1200 or 1-800-523-8852 ● Fax: (215) 355-7738  
Website: [www.bergerbuildingproducts.com](http://www.bergerbuildingproducts.com)  
E-mail: [info@bergerbuildingproducts.com](mailto:info@bergerbuildingproducts.com)